

**PHILIPS**

**HearLink**

AudioClip



# User Guide

HEA6000



# Warranty certificate

Date: \_\_\_\_\_ Model: \_\_\_\_\_

Warranty period: \_\_\_\_\_

Serial no.: \_\_\_\_\_

Hearing center

# International warranty

Your AudioClip is covered by an international limited warranty issued by the manufacturer for a period of 24 months from the date of delivery. This limited warranty covers manufacturing and material defects in the device itself, but not in accessories such as batteries, cables, power supplies, etc. Problems arising from improper/incorrect handling or care, excessive use, accidents, repairs made by an unauthorized party, exposure to corrosive conditions, damage due to foreign objects entering the device or incorrect adjustments are NOT covered by the limited warranty and may void it. The above warranty does not affect any legal rights that you might have under applicable national legislation governing sale of consumer goods. Your hearing care professional may have issued a warranty that goes beyond the clauses of this limited warranty. Please consult him/her for further information.

## **If you need service**

Take your AudioClip to your hearing care professional, who may be able to sort out minor problems and adjustments immediately.

# Introduction to this booklet

This booklet guides you on how to use and maintain your new AudioClip. Please read the booklet carefully, including the Warnings section. This will help you to get the most out of your new AudioClip.

If you have additional questions about the use of your AudioClip, please contact your hearing care professional.

More information is available on [hearingsolutions.philips.com](http://hearingsolutions.philips.com)

# Intended use

|                             |  |
|-----------------------------|--|
| <b>Intended use:</b>        | <b>AudioClip</b> is intended as a wireless receiver and transmitter of sound between <b>Philips</b> wireless hearing aids and the surrounding environment, including speech and wireless electronic audio devices. <b>AudioClip</b> furthermore assists hearing aids users to control the functionality provided by their hearing aid. |
| <b>Indications for use:</b> | No indications for use.  |
| <b>Intended user:</b>       | Adults and children older than 36 months.  |
| <b>Use environment:</b>     | Indoor / Outdoor.  |
| <b>Contraindications:</b>   | Users of active implants must pay special attention when using the device. For more information, read the Warning section.   |
| <b>Clinical benefits:</b>   | See clinical benefits of the hearing aid.  |

## Important Notice

Please familiarize yourself with the entire contents of this booklet before using your AudioClip. It contains instructions and important information about the use and handling of your AudioClip.

# Introduction

The AudioClip can be used both as a wireless headset for mobile phones and as a remote microphone/partner microphone.

## 1. Headset with mobile phone

Sounds from your phone will be streamed to your hearing aids through the AudioClip (A). Your voice is picked up by the AudioClip and sent to the mobile phone (B).

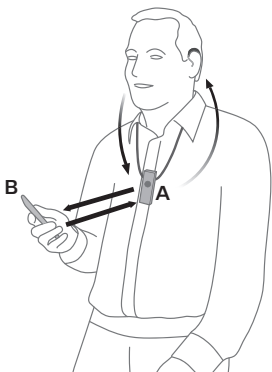

## 2. Remote/partner microphone

The voice of a chosen speaker will be transmitted wirelessly from the AudioClip to your hearing aids.

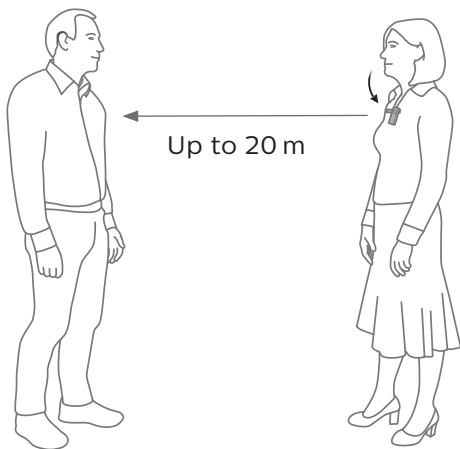

# Table of contents

|  |    |
|--|----|
| Overview – main functions                      | 12 |
| Overview – product indicators                  | 14 |
| Getting started                                | 16 |
| Daily use: On/Off                              | 22 |
| Daily use: Charging                            | 23 |
| Using AudioClip with a mobile phone            | 25 |
| Ensuring AudioClip is connected to the phone   | 26 |
| Receiving calls                                | 27 |
| Making calls                                   | 29 |
| Advanced headset features                      | 30 |
| Listening to music                             | 31 |
| Using AudioClip as remote microphone           | 33 |
| Selecting microphone mode                      | 34 |
| Starting/stopping sound from remote microphone | 35 |
| Regulating level from remote microphone        | 36 |

|  |    |
|--|----|
| Starting/stopping sound from remote microphone using your hearing aids | 37 |
| Using AudioClip as remote control for hearing aids                     | 38 |
| Other features and functions   | 39 |
| Cleaning the AudioClip   | 40 |
| Warnings   | 41 |
| Technical information  | 47 |



# Overview – main functions

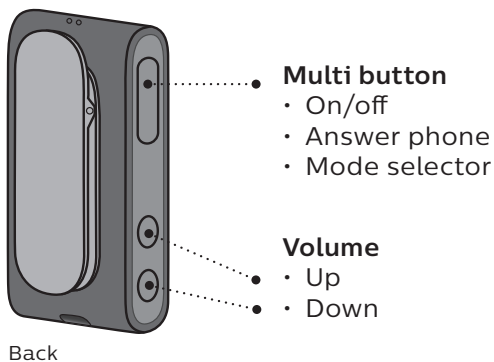
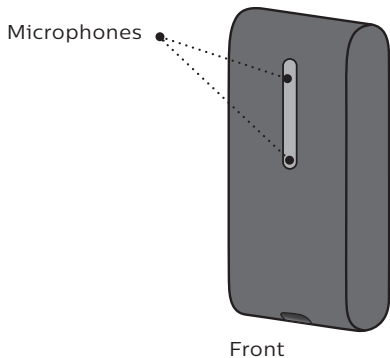

Status indicator    Power indicator

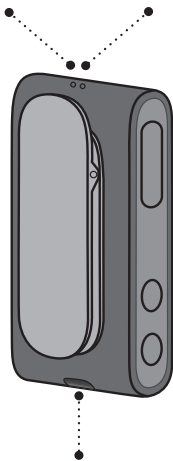

Charging socket  
(Micro USB)

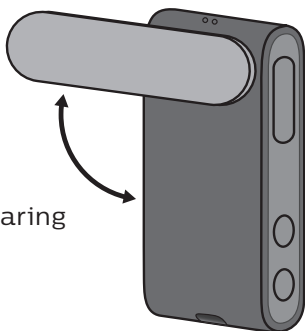

Clip (rotating) for wearing  
the AudioClip

# Overview – product indicators

| Status indicator | Mode  |
|------------------|---|
| Blinking yellow  | Searching for hearing aids                              |
| Steady yellow    | Idle. Hearing aids connected, not connected to a phone. |
| Blinking blue    | Searching for a mobile phone (pairing)                  |
| Steady blue      | Connected to a mobile phone                             |
| Steady green     | In a call   |
| Blinking green   | Incoming call   |
| Steady orange    | Streaming music   |
| Steady magenta   | Remote microphone mode                                  |
| Blinking magenta | Remote microphone reconnecting                          |

| <b>Power indicator</b> | <b>Mode</b>                    |
|------------------------|--------------------------------|
| Steady red             | Battery low                    |
| Steady green           | Turned on – not charging       |
| Blinking green         | Turned on – charging           |
| Fading green           | Turned on – charging complete  |
| Blinking orange        | Turned off – charging          |
| Steady orange          | Turned off – charging complete |
| No light               | Power off                      |

# Getting started

Before you can use the AudioClip with your hearing aids, both the hearing aids and the AudioClip need to be paired/connected. Using the AudioClip with a mobile phone also requires the AudioClip to be paired with/connected to your mobile phone.

## A. Pairing hearing aids and AudioClip

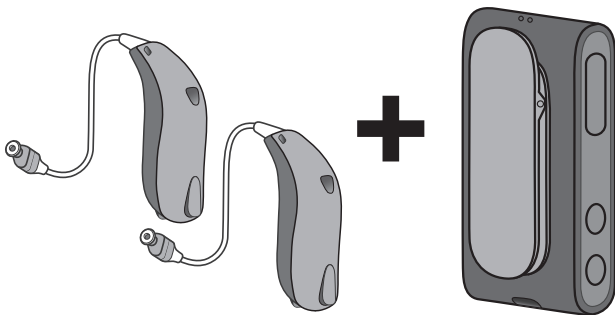

See page 18 for detailed instructions about pairing an AudioClip with your hearing aids.

## B. Pairing AudioClip and mobile phone

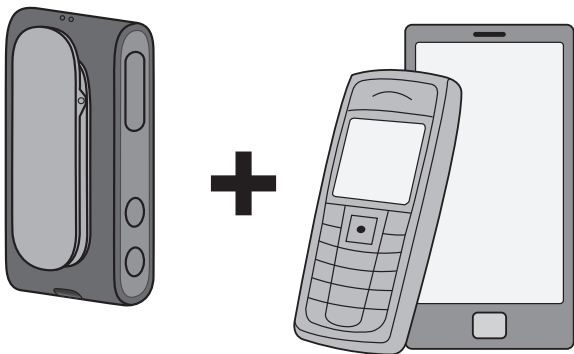

See page 20 for detailed instructions about pairing an AudioClip with your mobile phone.

## A. Pairing hearing aids with the AudioClip

1. **Ensure AudioClip is powered off**

Press and hold multi button for approx. 6 seconds until the power indicator is **OFF**.

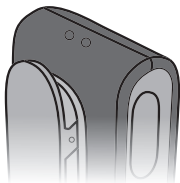

2. **Turn both hearing aids OFF**  
(open battery drawer)

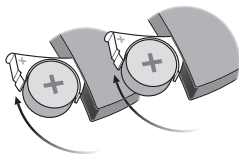

3. **Turn both hearing aids ON**

(close battery drawer)  
The hearing aids will now be ready for first time connection with the AudioClip. You now have 3 minutes to complete the pairing.

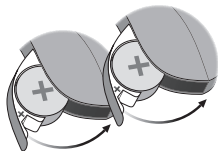

4. **Turn ON AudioClip**  
Press and hold multi button for approx. 3 seconds until power indicator shows **STEADY GREEN**.

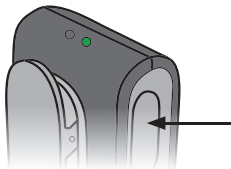

5. **AudioClip will now search for your hearing aids**  
Status indicator will be **BLINKING YELLOW**.



6. **Place AudioClip and both hearing aids close to each other (max. distance 20 cm)**

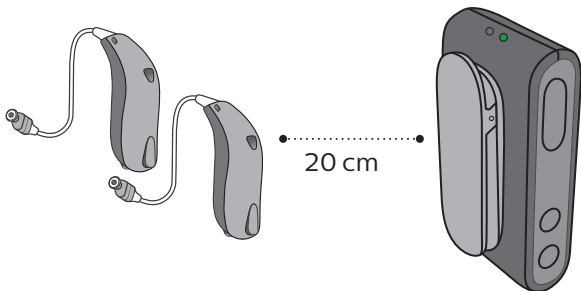

7. **Connection established with hearing aid(s)**  
This is indicated by status indicator **STEADY YELLOW**.



## B. Pairing mobile phone with the AudioClip

1. **Place AudioClip in pairing mode**  
Press and hold the multi button AND volume up button for about 6 seconds (A) until status indicator **BLINKS BLUE**.
2. **The AudioClip will be in pairing mode for about 3 minutes**

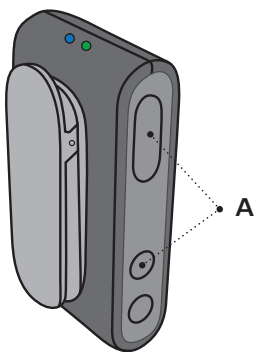

### 3. Enable pairing on mobile phone

Turn on Bluetooth®. Search for and connect to/pair with AudioClip.

This is normally in the settings -> Bluetooth® section of your phone.

### 4. Enter pin code

If your phone requests a pin code, enter 0000 (four zeros).

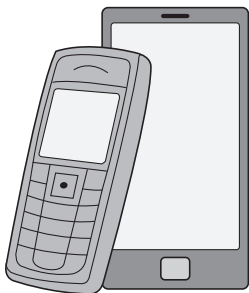

### 5. Pairing complete

Pairing complete with mobile phone is indicated by status indicator **STEADY BLUE.**



## Daily use: On/Off

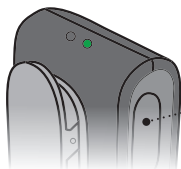

- **ON**

Press and hold multi button for approx. 3 seconds until power indicator shows **STEADY GREEN.**

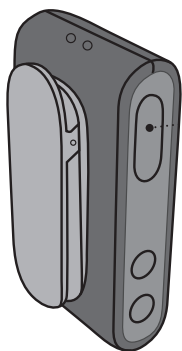

- **OFF**

Press and hold multi button for approx. 6 seconds until power indicator is **OFF.**

## Daily use: Charging



- **Battery low**  
With about 30 minutes remaining streaming time, the power indicator turns **RED**.

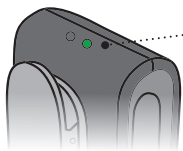

- **Charging**  
Connect the enclosed charger through the micro USB connector in the bottom of the AudioClip. The power indicator **BLINKS GREEN** or **ORANGE**.

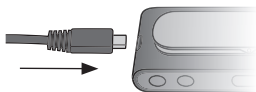

| <b>Power indicator</b> | <b>Mode</b>                    |
|------------------------|--------------------------------|
| Blinking green         | Turned on - charging           |
| Fading green           | Turned on - charging complete  |
| Blinking orange        | Turned off - charging          |
| Steady orange          | Turned off - charging complete |

### **Important notice**

When charging, the charging indicator should be lit as described in this booklet. If the charging indicator is not lit as described, disconnect the device from the charger and consult your hearing care professional.

### **Important notice**

When charging your AudioClip, please use the supplied original power supply 5.0 V/1A, CE and safety marked type:



# Using AudioClip with a mobile phone

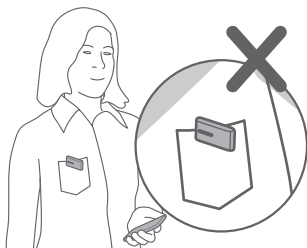
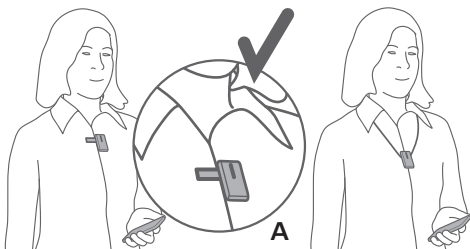

## **Important notice**

The AudioClip should be worn as indicated for best possible performance. It is important that the microphone in the AudioClip is pointing towards your mouth (A), and that the AudioClip is not covered by clothes etc. Maximum distance between AudioClip and mobile phone is 10 meters.

# Ensuring AudioClip is connected to the phone

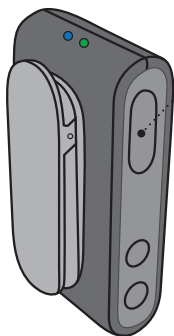

## Select phone mode

Press and hold multi button for approx. 3 seconds to change mode. Mode change is confirmed by an audible indication in your hearing aids. The status indicator is **STEADY BLUE**.



| Status indicator | Mode   |
|------------------|--|
| Steady yellow    | Hearing aids connected, not connected to a phone |
| Steady blue      | Connected to mobile phone                        |
| Steady magenta   | Remote microphone mode                           |

# Receiving calls

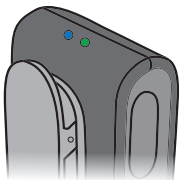

## Phone connected

When the AudioClip is turned on and in range of your mobile phone it will automatically connect to the mobile phone.

The status indicator is **STEADY BLUE**.



## Phone ringing

When the phone rings you will hear a ring indicator (and if available, the ring tone from your phone) in your hearing aids.

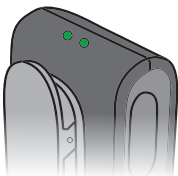

The status indicator will **BLINK GREEN**.



- **Answer call**

Either click the multi button (A) shortly – or answer the call from your mobile phone. Once the call is connected, the status indicator will change to **STEADY GREEN**.



- **End call**

Either click the multi button (A) shortly – or hang up the call from your mobile phone. Status indicator is **STEADY BLUE**.

# Making calls

To make a call you only have to use the mobile phone. The call will automatically be connected to the AudioClip.

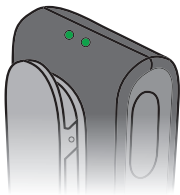

Once the call is connected the status indicator will change to **STEADY GREEN**.

# Advanced headset features

## **Voice dialing / voice command**

When connected to a mobile phone, double press on the multi button activates voice dialing if supported by the phone.

## **Reject call**

A long press on the volume down button, while the phone is ringing, rejects the call.

## **Mute hearing aid microphones**

Press and hold volume down for about 3 seconds to mute the hearing aid microphones.

Short press volume up or down will unmute hearing aids.

# Listening to music

## Wireless audio (A2DP)

If connected to a mobile phone, or other device, through Bluetooth®, the music played on the phone/device will automatically be played in your hearing aids.

Status indicator is **STEADY ORANGE**.

You do not need to operate anything on the AudioClip.

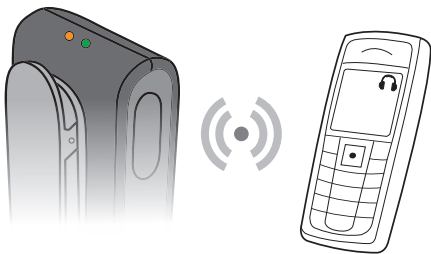

| Status indicator | Mode           |
|------------------|----------------|
| Steady orange    | Steaming music |

## Adjusting volume

While listening to music, the level of the streamed signal can be adjusted using the volume up/down buttons.

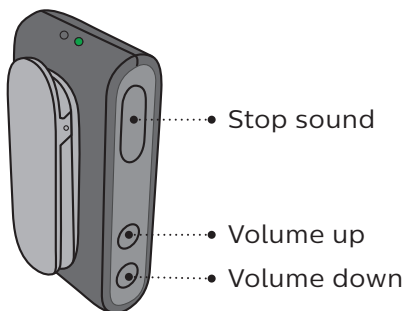

## Stopping sound from phone

Short press on the multi button will stop sound. Use the controls on the phone to start the sound.

# Using AudioClip as remote microphone

## Remote microphone

In this mode, speech from the person wearing the AudioClip will be streamed directly to your hearing aids.

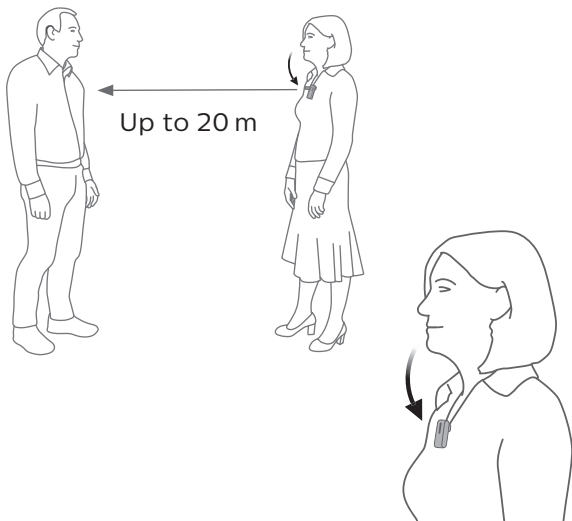

### Important notice

Ensure that the microphone is pointing to the speaker's mouth and that it is not covered by clothes etc.

# Selecting microphone mode

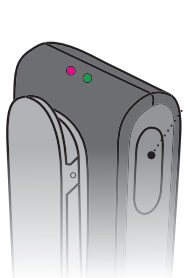

- **Select microphone mode**

Press and hold multi button for approx. 3 seconds to change mode.

Mode change is confirmed by an audible indication in your hearing aids.



Status indicator is **STEADY MAGENTA.**

| Status indicator | Mode   |
|------------------|--|
| Steady yellow    | Hearing aids connected, not connected to a phone |
| Steady blue      | Connected to mobile phone                        |
| Steady magenta   | Remote microphone mode                           |

## Starting/stopping sound from remote microphone

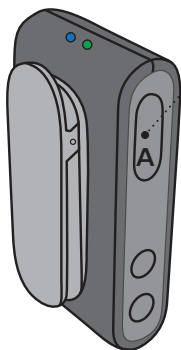

- **Stop sound from microphone**  
Press and hold multi button (A) for approx. 3 seconds to stop the signal from the microphone to the hearing aids and switch the hearing aids back to their normal program.

The status indicator will change to **STEADY YELLOW** or **STEADY BLUE**.

# Regulating level from remote microphone

## Volume up or volume down

The streamed signal can be adjusted using the volume up/down buttons.

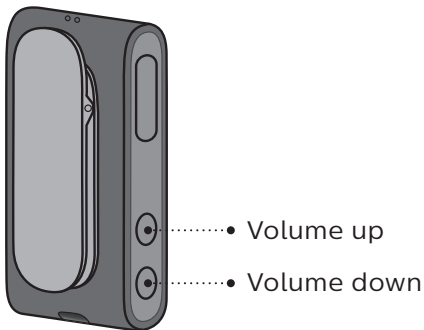

## Mute hearing aid microphones (only sound from the remote microphone)

Press and hold volume down for about 3 seconds to mute the hearing aid microphones.

Short press volume up or down will unmute hearing aids.

# Starting/stopping sound from remote microphone using your hearing aids

P1 → P2 → TV →

## Microphone

A press on the hearing aid button will toggle to the next program in the hearing aids.

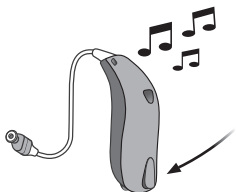

Once you reach the remote microphone program you will hear the remote microphone program indicator.

To stop remote microphone sound simply toggle back to wanted hearing aid program.

### **Important notice**

Please refer to your hearing aid's User Guide for details on the functionality of your specific hearing aid solution.

# Using AudioClip as remote control for hearing aids

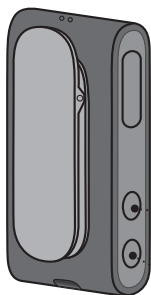

When AudioClip is not streaming sound it doubles as a remote control for your hearing aids.

- **Volume up**  
Short press

- **Volume down**  
Short press



- **Next program**  
Press and hold for 3 seconds for next program

- **Mute hearing aid microphones – long press**  
Short press on volume up or down will unmute

## Important notice

Maximum distance between AudioClip and hearing aids is 2 meters.

# Other features and functions

## **One connection at a time**

When paired with several devices (up to eight), the AudioClip will only connect to the first phone available/in range.

## **No calls when used as microphone**

When using the AudioClip as partner/remote microphone, there will be no connection to the mobile phone.

## **Timeout (out of range) when in microphone mode**

If the AudioClip is out of range of the hearing aids, the hearing aids will return to their initial program after 90 seconds.

## **Clear Bluetooth® pairings**

Press and hold multi button, volume up and volume down for 10 seconds to clear all Bluetooth® pairings. Clearing completed is indicated by status indicator **BLINKING RED.**

# Cleaning the AudioClip

Use a soft, dry cloth to clean the AudioClip.

**Important notice**

The AudioClip must never be washed or immersed in water or other liquids.

## **⚠ Warnings**

For your personal safety and to ensure correct usage, you should familiarise yourself fully with the following general warnings before using your AudioClip. Consult your hearing care professional if you experience unexpected operations or serious incidents with your AudioClip during use or because of its use. Your hearing care professional will support you with issue handling and, if relevant, reporting to the manufacturer and/or the national authorities.

### **Choking hazards and risk of swallowing small parts**

AudioClip and its parts should be kept out of reach of children and anyone who might swallow these items or otherwise cause injury to themselves. If a small part is swallowed, see a doctor immediately.

### **Explosives**

The AudioClip is safe to use under normal usage conditions. The AudioClip has not been tested for compliance with international standards concerning explosive environments. Therefore, do not use your AudioClip in environments with danger of explosions e.g. mines, oxygen rich environments or areas where flammable anaesthetics are handled.

## **X-ray/CT/MR/PET scanning, electrotherapy and surgery**

Remove your AudioClip before X-ray/CT/MR/PET scannings, electrotherapy, surgery, etc. as your AudioClip may be damaged when exposed to strong electromagnetic fields.

## **Heat and chemicals**

The AudioClip must never be exposed to extreme heat, for example, left inside a parked car in the sun. The AudioClip must not be dried in microwave ovens or other ovens. The chemicals in cosmetics, hairspray, perfume, aftershave lotion, suntan lotion and insect repellent can damage the AudioClip. Always remove your AudioClip before applying such products and allow time to dry before use.

## **Interference**

The AudioClip has been thoroughly tested for interference according to the most stringent international standards. However, interference between the AudioClip and other devices (e.g. some mobile telephones, citizens band devices, shop alarm systems and other wireless devices) may occur. If this occurs, increase the distance between the AudioClip and the interfering device.

## Warnings

### **Use in traffic**

Using the AudioClip can distract you. Be aware of your surroundings while using the AudioClip. Please refer to national traffic laws regarding the use of communication devices while in traffic.

### **Use on aircraft**

Your AudioClip contains Bluetooth®. The AudioClip should not be used on board an aircraft, unless specifically permitted by the flight personnel.

### **Active implants**

The AudioClip has been thoroughly tested and characterized for human health according to international standards for human exposure (Specific Absorption Ratio – SAR), induced electromagnetic power and voltages into the human body. The exposure values are well below international accepted safety limits for SAR, induced electromagnetic power and voltages into the human body defined in the standards for human health and coexistence with active medical implants as pacemakers and heart defibrillators.

## **Rechargeable battery**

Do not attempt to open the AudioClip, as this may damage the battery.

Never attempt to replace the battery. If battery replacement is needed, please return device to the supplier. The service guarantee is void if there are signs of tampering.

The safety of recharging batteries using a USB connector is determined by the external signal source. When connected to external equipment plugged into a wall outlet, this equipment must comply with IEC-62368-1 or equivalent safety standards.

## **Connection to external equipment**

The safety of the use of AudioClip when connected to external equipment (via auxiliary input cable, via USB cable, or directly), is determined by the external equipment. When connected to external equipment plugged into a wall outlet, this equipment must comply with IEC-62368-1 or equivalent safety standards.

## **Warnings**

### **Cross control**

Your AudioClip should be kept out of reach of children or anyone who might take control of the functionality, to ensure your personal safety and avoid incorrect use.

### **Use of lanyard**

If by accident the lanyard is caught on something while wearing it, the lanyard is designed to break automatically. Therefore, never try to shorten or modify the lanyard in an unauthorized way. The lanyard should not be used by children under 36 months of age.

### **Possible side effects**

The otherwise non-allergenic materials used in your AudioClip may in rare cases cause a skin irritation or other side effects. Please, seek consultation with a physician if these conditions occur.

### **Incompatible non-supplied accessories**

Only use accessories, transducers or cables supplied by the manufacturer. Incompatible accessories may result in reduced electromagnetic compatibility (EMC) of your device.

## **Charging**

To prevent potential battery damage during storage please charge the AudioClip every 6 months.

## **Mobile phone compatibility**

Please refer to

[www.hearingsolutions.philips.com](http://www.hearingsolutions.philips.com) for a list of mobile phones that have been tested comprehensively by Philips, and have been found to fulfil the minimum requirements for compatibility at the time of testing. However, Philips takes no responsibility for such compatibility in general. Specifically, Philips shall not be responsible for incompatibility resulting from future updates of the mobile phones, nor from events of incompatibility not covered by and/or found in these tests. Philips takes no financial responsibility in terms of reimbursements of mobile phones that do not work as expected. Before purchasing a new mobile phone, you are advised to consult the list mentioned above.

# Technical information

|                                       |  |
|---------------------------------------|--|
| Model name                            | AC1A   |
| GTIN                                  | 05714464003662   |
| <b>Conditions of Use</b>              |  |
| FCC/IC                                | FCC ID: 2ACAHAC01<br>IC: 11936A-AC01   |
| Compatibility                         | Philips 2.4 GHz wireless hearing instruments   |
| Dimensions                            | 53 x 27 x 18 mm; weight 27 g   |
| Operating conditions                  | Temperature: +5 °C to +40 °C<br>(41 °F to 104 °F)<br><br>Humidity: 15% to 93%,<br>relative humidity,<br>non-condensing<br><br>Atmospheric<br>pressure: 700 hPa to 1060 hPa   |
| Storage and transportation conditions | Temperature and humidity shall not exceed the below limits for extended periods during transportation and storage:<br>Temperature: -20 °C to +60 °C<br>(-4 °F to +140 °F)<br><br>Humidity: 15% to 93%,<br>relative humidity,<br>non-condensing<br><br>Atmospheric<br>pressure: 700 hPa to 1060 hPa |

|                              |  |
|------------------------------|--|
| System features              | Mobile phone headset (handsfree/headset profile) & stereo music (A2DP)<br>Remote/Partner microphone  |
| Remote control of HI         | Volume, program shift and mute of microphones in hearing instruments   |
| Battery <sup>1</sup>         | Typical daily use 16 hours:<br>2 hours audio streaming + 2 hours phone + 12 hours standby 36 h standby (turned on, no streaming)<br>Charge time: 2 hours<br>Battery total life expectancy: 80% capacity left after 720 charge/re-charge cycles |
| Audio quality <sup>2</sup>   | Stereo/20 kHz sample freq.   |
| Audio bandwidth <sup>2</sup> | 80 Hz – 10 kHz   |
| Pairing details              | Up to 8 paired Bluetooth® devices  |
| Bluetooth® compliance        | Version 4.2 + EDR  |
| Bluetooth® profile support   | Advanced Audio Distribution Profile (A2DP) 1.3<br>Headset Profile (HSP) 1.2<br>Hands-Free Profile (HFP) 1.6 including support for Wideband Speech  |
| Wireless range <sup>3</sup>  | 10 meters with Bluetooth® Class 2 devices (e.g. mobile phones) up to 20 meters between AudioClip and hearing instruments   |
| Streaming frequency          | 2.4 GHz (Bluetooth® band)  |

|                             |  |
|-----------------------------|--|
| Emissions                   | Max. 17 dBm e.i.r.p. in compliance with all relevant standards |
| Status indications          | LEDs on the AudioClip. Acoustic signals in hearing instruments |
| HearSuite 2019.1 (or later) | Fitting of streaming programs                                  |

- <sup>1</sup> Using the supplied charger
- <sup>2</sup> Actual audio performance depending on client's hearing instruments
- <sup>3</sup> Free line of sight between the AudioClip and other devices. Other devices operating in the 2.4 GHz band may interfere and reduce range.

The AudioClip contains a radio transceiver using Bluetooth, Bluetooth Low Energy (BLE) and a proprietary short range radio technology both working at ISM band 2.4 GHz. The GHz radio transmitters are weak and always below 50 mW equal to 17 dBm in total radiated power. The AudioClip complies with international standards concerning radio transmitters, electromagnetic compatibility and human exposure.

Due to the limited space available on the AudioClip, relevant approval markings can be found in this booklet.

## **USA and Canada**

This device contains a radio module with the following certification ID numbers:

FCC ID: 2ACAHAC01

IC: 11936A-AC01

The device complies with Part 15 of the FCC Rules and with Industry Canada's licence-exempt RSSs.





Operation is subject to the following two conditions:







1. this device may not cause harmful interference, and
2. this device must accept any interference received, including interference that may cause undesired operation.

### **Notice:**

Changes or modifications not expressly approved by the party responsible for compliance could void the user's authority to operate the equipment.

## Description of symbols used in this booklet or on the packaging label

|   |   |
|---|---|
|    | <p><b>Warnings</b><br/>Text marked with a warning symbol must be read before using the device.</p>  |
|    | <p><b>Manufacturer</b><br/>The device is produced by the manufacturer whose name and address are stated next to the symbol. Indicates the medical device manufacturer, as defined in EU Regulations 2017/745 and 2017/746.</p>  |
|    | <p><b>CE mark</b><br/>The device complies with all required EU regulations and directives.</p>  |
|    | <p><b>Electronic waste (WEEE)</b><br/>Recycle hearing aids, accessories or batteries according to local regulations. Hearing aid users can also return electronic waste to their hearing care professional for disposal. Electronic equipment covered by Directive 2012/19/EU on waste and electrical equipment (WEEE).</p> |
|  | <p><b>Regulatory Compliance Mark (RCM)</b><br/>The device complies with electrical safety, EMC and radio spectrum requirements for devices supplied to the Australian or New Zealand market.</p>  |

|  |  |
|--|--|
|   | <p><b>Double insulation</b><br/>Indicates that product power supply is double insulated. This means a very low risk of single fault failures i.e. single fault failures cannot occur.</p>  |
|   | <p><b>Indoor use</b><br/>Indicates that the product is qualified for indoor use.</p>   |
|   | <p><b>Battery recycling symbol</b><br/>Li-Ion Battery recycling symbol.</p>  |
| <div data-bbox="161 643 381 751" style="border: 1px solid black; padding: 5px; width: fit-content; margin: auto;"> <p>Complies with<br/>IMDA Standards<br/>DA103820</p> </div> | <p><b>Singapore IMDA label</b><br/>Indicates that the device complies with the standards and specification published by Info-Communications Media Development Authority (IMDA) and is compatible with the public telecommunication networks in Singapore and does not cause radio frequency interference to other authorized radio-communication networks.</p> |
|    | <p><b>South Africa ICASA label</b><br/>Indicates that the device has license to be sold in South Africa.</p>   |
|   | <p><b>Japan TELEC symbol</b><br/>Indicates mark for certified radio equipment.</p>   |
|   | <p><b>Brazil ANATEL label</b><br/>Indicates that the device is certified and homologated in Brazil.</p>  |
|   | <p><b>Medical Device</b><br/>The device is a medical device.</p>   |

|   |   |
|---|---|
|  | <p><b>Keep dry</b><br/>Indicates a medical device that needs to be protected from moisture.</p>   |
| <p><b>REF</b></p>   | <p><b>Catalogue number</b><br/>Indicates the manufacturer's catalogue number so that the medical device can be identified.</p>                      |
| <p><b>SN</b></p>  | <p><b>Serial number</b><br/>Indicates the manufacturer's serial number so that a specific medical device can be identified.</p>                     |
| <p><b>Rated input:</b><br/>5,0 V<math>\overline{=}</math>0,4 A</p>                | <p><b>Power supply outlet</b><br/>Indicates the rate at which power is sent from the outlet to your electrical device.</p>                          |
| <p><b>CTN</b></p>   | <p><b>CTN</b><br/>CTN is a commercial unique part-number used for sales and customers to identify each product type wearing Philips brand name.</p> |
| <p><b>CMIIT</b><br/>2017DJ6897</p>  | <p><b>China CMIIT ID</b><br/>Indicates that the device is certified in China.</p>   |
| <p><b>UDI</b></p>   | <p><b>Unique device identifier</b><br/>Indicates a carrier that contains unique device identifier information</p>                                   |

**REACH Declaration:**

REACH requires Philips Hearing Solutions to provide chemical content information for Substances of Very High Concern (SVHC) if they are present above 0.1% of the article weight. No substances on the REACH SVHC list applicable at the time of manufacturing is present in Product HearLink. More recent information can be found on the website [hearingsolutions.philips.com/REACH](https://hearingsolutions.philips.com/REACH).

The manufacturer declares that this AudioClip (AC1A) is in compliance with the essential requirements and other relevant provisions of Directive 2014/53/EU. This medical device complies with Medical Device Regulation (EU) 2017/745. The Declaration of Conformity is available from the manufacturer.



**SBO Hearing A/S**  
**Kongebakken 9**  
**DK-2765 Smørum**  
**Denmark**  
**[www.sbohearing.com](http://www.sbohearing.com)**



Complies with  
IMDA Standards  
DA103820



Waste from electronic  
equipment must be  
handled according to  
local regulations.



**Bluetooth®**

< >  
8,15 mm



> 19 mm

< >  
9,0 mm

< 15 mm

>

hearingsolutions.philips.com



Philips and the Philips Shield Emblem are registered trademarks of Koninklijke Philips N.V. and are used under license. This product has been manufactured by or for and is sold under the responsibility of SBO Hearing A/S, and SBO Hearing A/S is the warrantor in relation to this product.



214092UK / 2023.05.08 / v2 / Firmware 1.x